

# SST43D SERIES

42mm ( NEMA 17 )

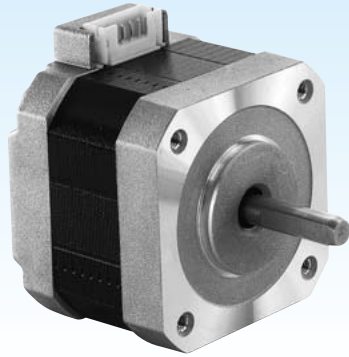

## ハイブリッドステップモータ(2相) 2 Phase Hybrid Step Motor

バイポーラ標準タイプ **Bipolar Standard Model**

- 1.8°
- RoHS
- Bipolar
- Post Connector

### SPECIFICATIONS

MODEL	STEP ANGLE	VOLTAGE	CURRENT	RESISTANCE	INDUCTANCE	HOLDING TORQUE	ROTOR INERTIA	NUMBER OF LEADS	MASS	LENGTH
	deg	V	A/	/	mH/	mN·m	g·cm <sup>2</sup>	LEAD	g	mm
SST43D104X	1.8	6.8	0.57	12.00	16.0	294	33	4	230	34
SST43D106X	1.8	4.9	0.85	5.75	8.1	304	33	4	230	34
SST43D108X	1.8	3.6	1.13	3.20	4.9	312	33	4	230	34
SST43D110X	1.8	3.0	1.41	2.10	3.3	319	33	4	230	34
SST43D112X	1.8	2.3	1.70	1.35	2.3	322	33	4	230	34
SST43D115X	1.8	1.9	2.12	0.90	1.5	309	33	4	230	34
SST43D204X	1.8	8.6	0.57	15.00	24.0	420	56	4	290	40
SST43D206X	1.8	5.1	0.85	6.00	11.8	432	56	4	290	40
SST43D208X	1.8	3.9	1.13	3.45	7.1	422	56	4	290	40
SST43D210X	1.8	3.4	1.41	2.40	4.8	441	56	4	290	40
SST43D212X	1.8	2.8	1.70	1.65	3.6	456	56	4	290	40
SST43D214X	1.8	2.3	1.98	1.15	2.5	441	56	4	290	40
SST43D216X	1.8	2.1	2.26	0.95	1.8	424	56	4	290	40

末尾 (Final Number) 5 : 片軸 (Single Shaft) 6 : 両軸 (Double Shaft)

### DIMENSIONS (Example)

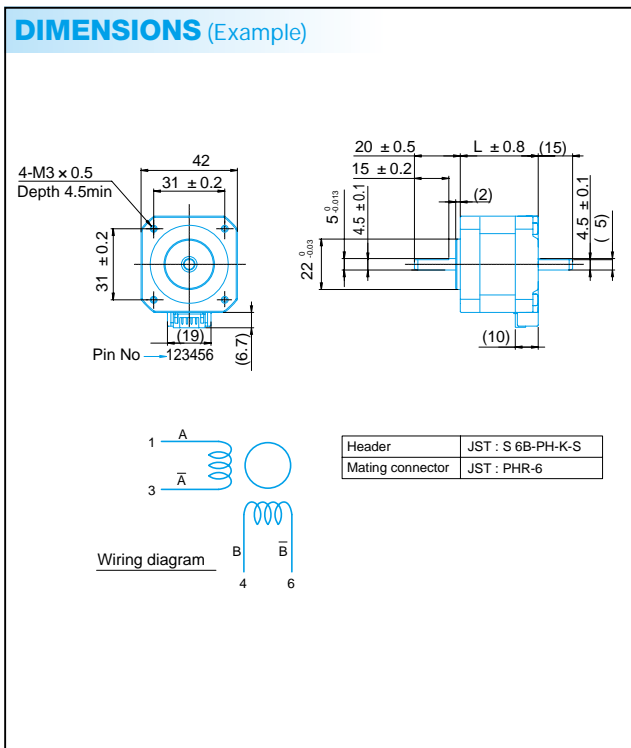

### SST43D1045

DRIVER : TYPE D  
VOLTAGE = DC24V  
CURRENT = 0.57 A/Phase  
EXCITING MODE : 2 Phase  
INERTIA LOAD : 3g·cm<sup>2</sup>

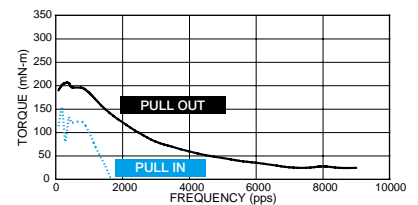

### SST43D1065

DRIVER : TYPE D  
VOLTAGE = DC24V  
CURRENT = 0.85 A/Phase  
EXCITING MODE : 2 Phase  
INERTIA LOAD : 3g·cm<sup>2</sup>

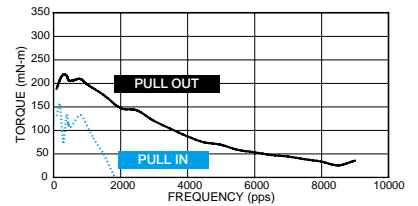

### SST43D1085

DRIVER : TYPE D  
VOLTAGE = DC24V  
CURRENT = 1.13 A/Phase  
EXCITING MODE : 2 Phase  
INERTIA LOAD : 3g·cm<sup>2</sup>

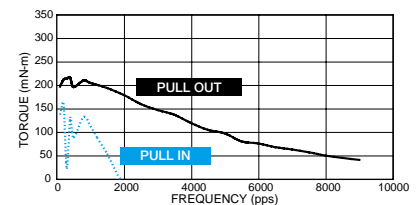

Step Motor  
Brushless Motor  
AC Induction Type  
Special Products

### SST43D1105

DRIVER : TYPE D  
 VOLTAGE = DC24V  
 CURRENT = 1.41 A/Phase  
 EXCITING MODE : 2 Phase  
 INERTIA LOAD : 3g-cm<sup>2</sup>

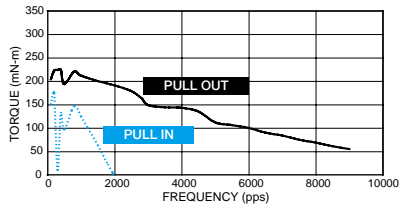

### SST43D1125

DRIVER : TYPE D  
 VOLTAGE = DC24V  
 CURRENT = 1.70 A/Phase  
 EXCITING MODE : 2 Phase  
 INERTIA LOAD : 3g-cm<sup>2</sup>

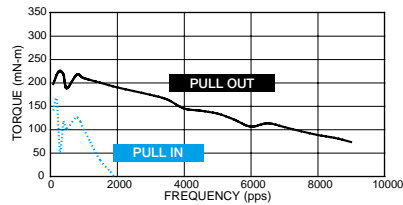

### SST43D1155

DRIVER : TYPE D  
 VOLTAGE = DC24V  
 CURRENT = 2.12 A/Phase  
 EXCITING MODE : 2 Phase  
 INERTIA LOAD : 3g-cm<sup>2</sup>

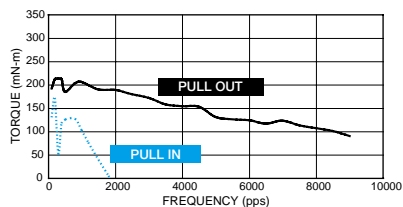

### SST43D2045

DRIVER : TYPE D  
 VOLTAGE = DC24V  
 CURRENT = 0.57 A/Phase  
 EXCITING MODE : 2 Phase  
 INERTIA LOAD : 3g-cm<sup>2</sup>

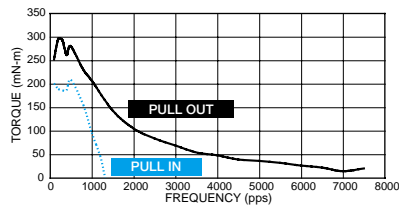

### SST43D2065

DRIVER : TYPE D  
 VOLTAGE = DC24V  
 CURRENT = 0.85 A/Phase  
 EXCITING MODE : 2 Phase  
 INERTIA LOAD : 3g-cm<sup>2</sup>

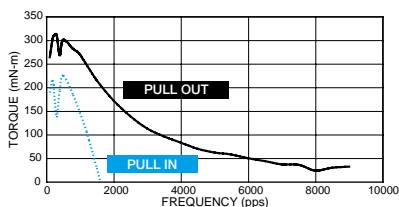

### SST43D2085

DRIVER : TYPE D  
 VOLTAGE = DC24V  
 CURRENT = 1.13 A/Phase  
 EXCITING MODE : 2 Phase  
 INERTIA LOAD : 3g-cm<sup>2</sup>

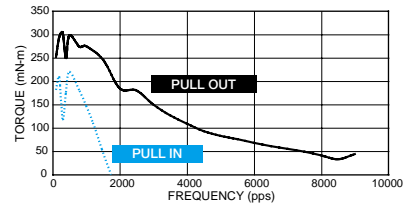

### SST43D2015

DRIVER : TYPE D  
 VOLTAGE = DC24V  
 CURRENT = 1.41 A/Phase  
 EXCITING MODE : 2 Phase  
 INERTIA LOAD : 3g-cm<sup>2</sup>

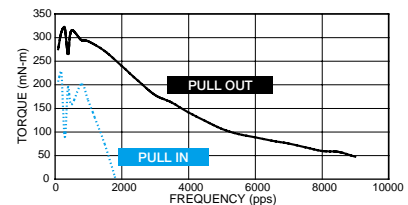

### SST43D2125

DRIVER : TYPE D  
 VOLTAGE = DC24V  
 CURRENT = 1.70 A/Phase  
 EXCITING MODE : 2 Phase  
 INERTIA LOAD : 3g-cm<sup>2</sup>

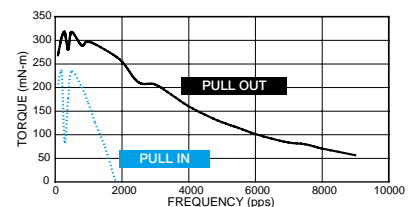

### SST43D2145

DRIVER : TYPE D  
 VOLTAGE = DC24V  
 CURRENT = 1.98 A/Phase  
 EXCITING MODE : 2 Phase  
 INERTIA LOAD : 3g-cm<sup>2</sup>

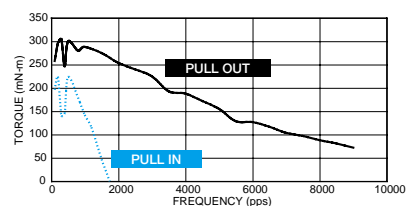

### SST43D2165

DRIVER : TYPE D  
 VOLTAGE = DC24V  
 CURRENT = 2.26 A/Phase  
 EXCITING MODE : 2 Phase  
 INERTIA LOAD : 3g-cm<sup>2</sup>

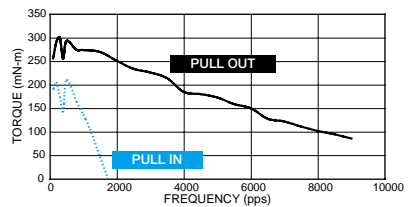

## INFORMATION

ご要求に応じて、巻線を最適にデザインいたします。

We can optimize motor winding based on customer requests.

モータ部寸のバリエーションは31.0mm ~ 47.5mmがあります。

Available motor length 31.0mm ~ 47.5mm

ご注意：使用ドライバ、駆動条件によっては、モータがかなり発熱することがあります。モータの外被温度は100℃以下でお使いください。  
 Note : Depending on driver and driving condition, motor may generate excessive temperature. Recommended temperature on motor surface is 100°C max.

# SST43D SERIES

42mm ( NEMA 17 )

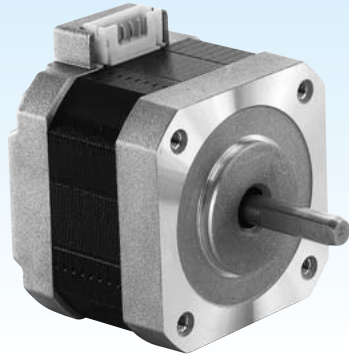

## ハイブリッドステップモータ(2相) 2 Phase Hybrid Step Motor

ユニポーラ標準タイプ Unipolar Standard Model

1.8°

RoHS

Unipolar

Post Connector

### SPECIFICATIONS

MODEL	STEP ANGLE	VOLTAGE	CURRENT	RESISTANCE	INDUCTANCE	HOLDING TORQUE	ROTOR INERTIA	NUMBER OF LEADS	MASS	LENGTH
	deg	V	A/	/	mH/	mN·m	g·cm <sup>2</sup>	LEAD	g	mm
SST43D104X	1.8	9.6	0.4	24.0	16.0	215	33	6	230	34
SST43D106X	1.8	6.9	0.6	11.5	8.1	226	33	6	230	34
SST43D108X	1.8	5.1	0.8	6.4	4.9	233	33	6	230	34
SST43D110X	1.8	4.2	1.0	4.2	3.3	238	33	6	230	34
SST43D112X	1.8	3.2	1.2	2.7	2.3	237	33	6	230	34
SST43D115X	1.8	2.7	1.5	1.8	1.5	235	33	6	230	34
SST43D204X	1.8	12.0	0.4	30.0	24.0	314	56	6	290	40
SST43D206X	1.8	7.2	0.6	12.0	11.8	322	56	6	290	40
SST43D208X	1.8	5.5	0.8	6.9	7.1	321	56	6	290	40
SST43D210X	1.8	4.8	1.0	4.8	4.8	338	56	6	290	40
SST43D212X	1.8	4.0	1.2	3.3	3.6	341	56	6	290	40
SST43D214X	1.8	3.2	1.4	2.3	2.5	329	56	6	290	40
SST43D216X	1.8	3.0	1.6	1.9	1.8	313	56	6	290	40

└ 末尾 (Final Number) 0 : 片軸 (Single Shaft) 1 : 両軸 (Double Shaft)

### DIMENSIONS (Example)

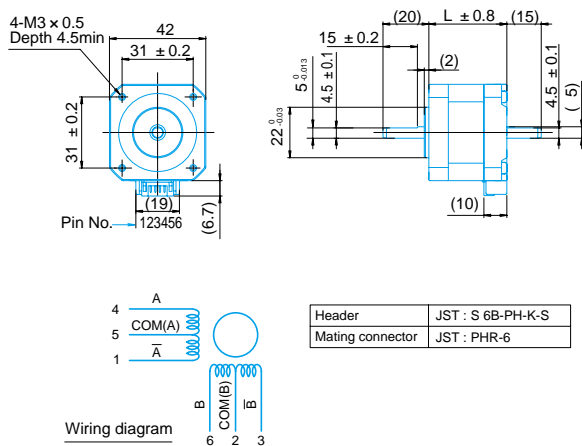

### SST43D1040

VOLTAGE = DC24V  
CURRENT = 0.4 A/Phase  
EXCITING MODE : 2 Phase  
INERTIA LOAD : 3g·cm<sup>2</sup>

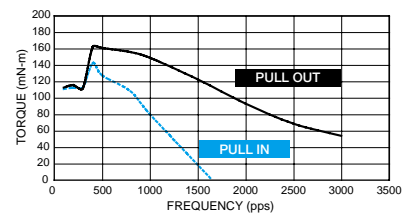

### SST43D1060

VOLTAGE = DC24V  
CURRENT = 0.6 A/Phase  
EXCITING MODE : 2 Phase  
INERTIA LOAD : 3g·cm<sup>2</sup>

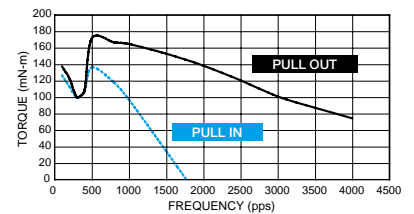

### SST43D1080

VOLTAGE = DC24V  
CURRENT = 0.8 A/Phase  
EXCITING MODE : 2 Phase  
INERTIA LOAD : 3g·cm<sup>2</sup>

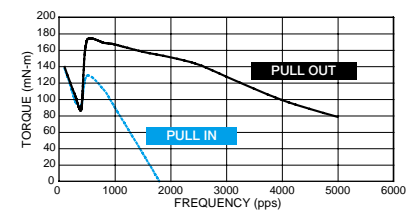

### SST43D1100

VOLTAGE = DC24V  
CURRENT = 1.0 A/Phase  
EXCITING MODE : 2 Phase  
INERTIA LOAD : 3g-cm<sup>2</sup>

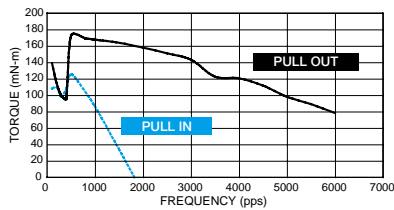

### SST43D2080

VOLTAGE = DC24V  
CURRENT = 0.8 A/Phase  
EXCITING MODE : 2 Phase  
INERTIA LOAD : 3g-cm<sup>2</sup>

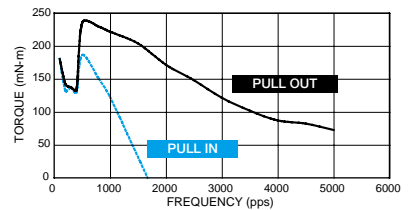

### SST43D1120

VOLTAGE = DC24V  
CURRENT = 1.2 A/Phase  
EXCITING MODE : 2 Phase  
INERTIA LOAD : 3g-cm<sup>2</sup>

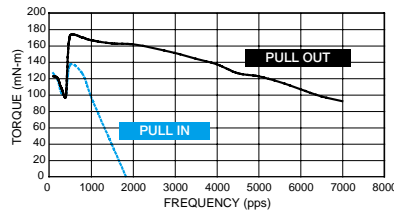

### SST43D2100

VOLTAGE = DC24V  
CURRENT = 1.0 A/Phase  
EXCITING MODE : 2 Phase  
INERTIA LOAD : 3g-cm<sup>2</sup>

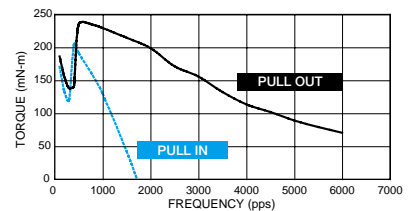

### SST43D1150

VOLTAGE = DC24V  
CURRENT = 1.5 A/Phase  
EXCITING MODE : 2 Phase  
INERTIA LOAD : 3g-cm<sup>2</sup>

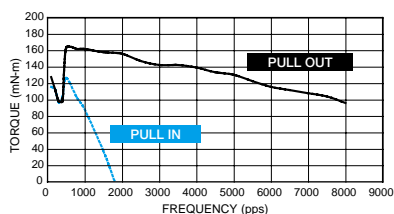

### SST43D2120

VOLTAGE = DC24V  
CURRENT = 1.2 A/Phase  
EXCITING MODE : 2 Phase  
INERTIA LOAD : 3g-cm<sup>2</sup>

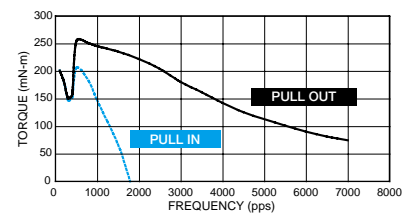

### SST43D2040

VOLTAGE = DC24V  
CURRENT = 0.4 A/Phase  
EXCITING MODE : 2 Phase  
INERTIA LOAD : 3g-cm<sup>2</sup>

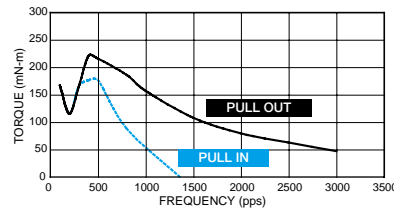

### SST43D2140

VOLTAGE = DC24V  
CURRENT = 1.4 A/Phase  
EXCITING MODE : 2 Phase  
INERTIA LOAD : 3g-cm<sup>2</sup>

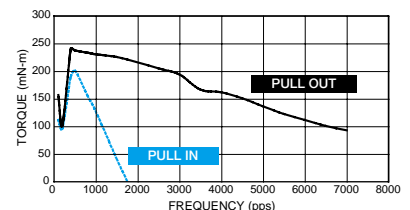

### SST43D2060

VOLTAGE = DC24V  
CURRENT = 0.6 A/Phase  
EXCITING MODE : 2 Phase  
INERTIA LOAD : 3g-cm<sup>2</sup>

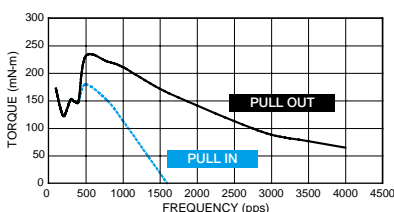

### SST43D2160

VOLTAGE = DC24V  
CURRENT = 1.6 A/Phase  
EXCITING MODE : 2 Phase  
INERTIA LOAD : 3g-cm<sup>2</sup>

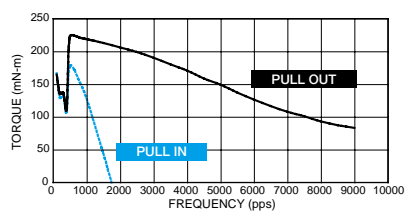

## INFORMATION

ご要求に応じて、巻線を最適にデザインいたします。

We can optimize motor winding based on customer requests.

モータ部寸のバリエーションは31.0mm ~ 47.5mmがあります。

Available motor length 31.0mm ~ 47.5mm

ご注意：使用ドライバ、駆動条件によっては、モータがかなり発熱することがあります。モータの外被温度は100℃以下でお使いください。  
Note: Depending on driver and driving condition, motor may generate excessive temperature. Recommended temperature on motor surface is 100°C max.